



◀ 26'-0" ▶

▲ 37'-0" ▼



Plan | 897R

Living Area | 897 sq ft

Bedrooms | 2

Baths | 1



Got Questions? Call Now! (800) 969-5946

On Your Lot, On Time, Built Right! | HiLineHomes.com

Revised 8/12/2016 | ©1996-2016 All Rights Reserved - HiLine Homes. Washington # HILINH*983BD, HILINH*845D3, HILINH*841JA | Oregon CCB# 182300, CCB# 181069, CCB#181652, CCB# 210297 | California CCSLB# 1001720. Any use, modification or derivative works of floor plans without permission constitutes copyright infringement. Plan numbers indicate approximate square footage of living space. Renderings of elevations shown may reflect artist's interpretation and/or optional features, and may not represent the finished product. Builder reserves the right to change specifications and price without notice or obligation.



◀ 26'-0" ▶

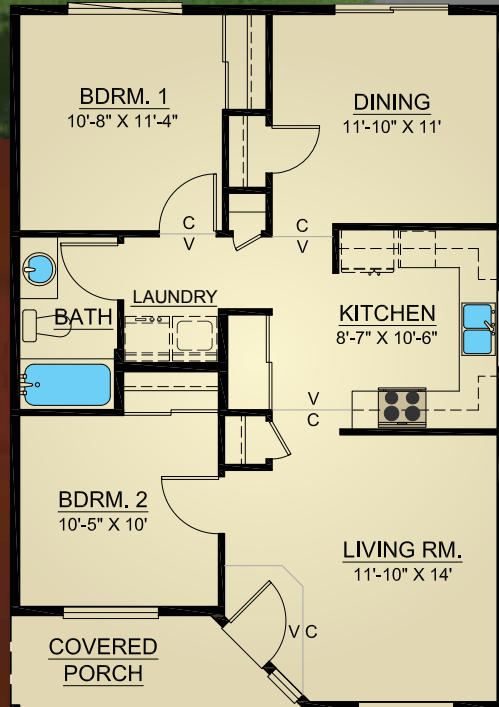

▲ 37'-0" ▼

Plan | 897L

Living Area | 897 sq ft

Bedrooms | 2

Baths | 1



Got Questions? Call Now! (800) 969-5946

On Your Lot, On Time, Built Right! | HiLineHomes.com

Revised 8/12/2016 | ©1996-2016 All Rights Reserved - HiLine Homes. Washington # HILINH*983BD, HILINH*845D3, HILINH*841JA | Oregon CCB# 182300, CCB# 181069, CCB#181652, CCB# 210297 | California CCSLB# 1001720. Any use, modification or derivative works of floor plans without permission constitutes copyright infringement. Plan numbers indicate approximate square footage of living space. Renderings of elevations shown may reflect artist's interpretation and/or optional features, and may not represent the finished product. Builder reserves the right to change specifications and price without notice or obligation.